



Business Services

Contracts Office

5735 47th Avenue • Sacramento, CA 95824
(916) 643-2464

*Janea Marking, Chief Business Officer
Robert Aldama, Purchasing Manager II*

ADDENDUM NO. 2

Date: 11/25/2024

Issued by: Sacramento City Unified School District

**Project: RFP #0040-408 & #0510-404
Pacific Interim Housing @ Clayton B. Wire and C.K. McClatchy Class Size
Reduction (Portable Relocation)**

This addenda shall supersede the original Information, attachments, and specifications regarding RFP #0040-408 & #0510-404 where it adds to, deletes from, clarifies or otherwise modifies them. All other conditions and any previous addenda shall remain unchanged.

PART A – RFQ/P

AD2.01 Refer to Request for Proposal (RFP) #0040-408 & #0510-404, Exhibit B Preliminary Site Plan:

Replace RFP Exhibit B, in its entirety.

- Revised to include a site plan and photos of the project portables.

END OF ADDENDUM NO. 2

Vendor to sign as acknowledgment of receipt and return with Proposal:

Signature: _____ Date: _____

Company Name (please print) _____

EXHIBIT B

PRELIMINARY SITE PLAN

Project portables located at Kemble-Chavez Elementary 7495 29th St, Sacramento, CA 95822



3/3/2023 10:24:09 AM
 BIM 360://022063 SCSIED Chavez - Kemble ES/022063_ARCHSITE_R20_CENTRAL.rvt
 IF THIS SHEET IS NOT 30"x42" IT IS A REDUCED PRINT - SCALE ACCORDINGLY. 0' 1/8" = 1'

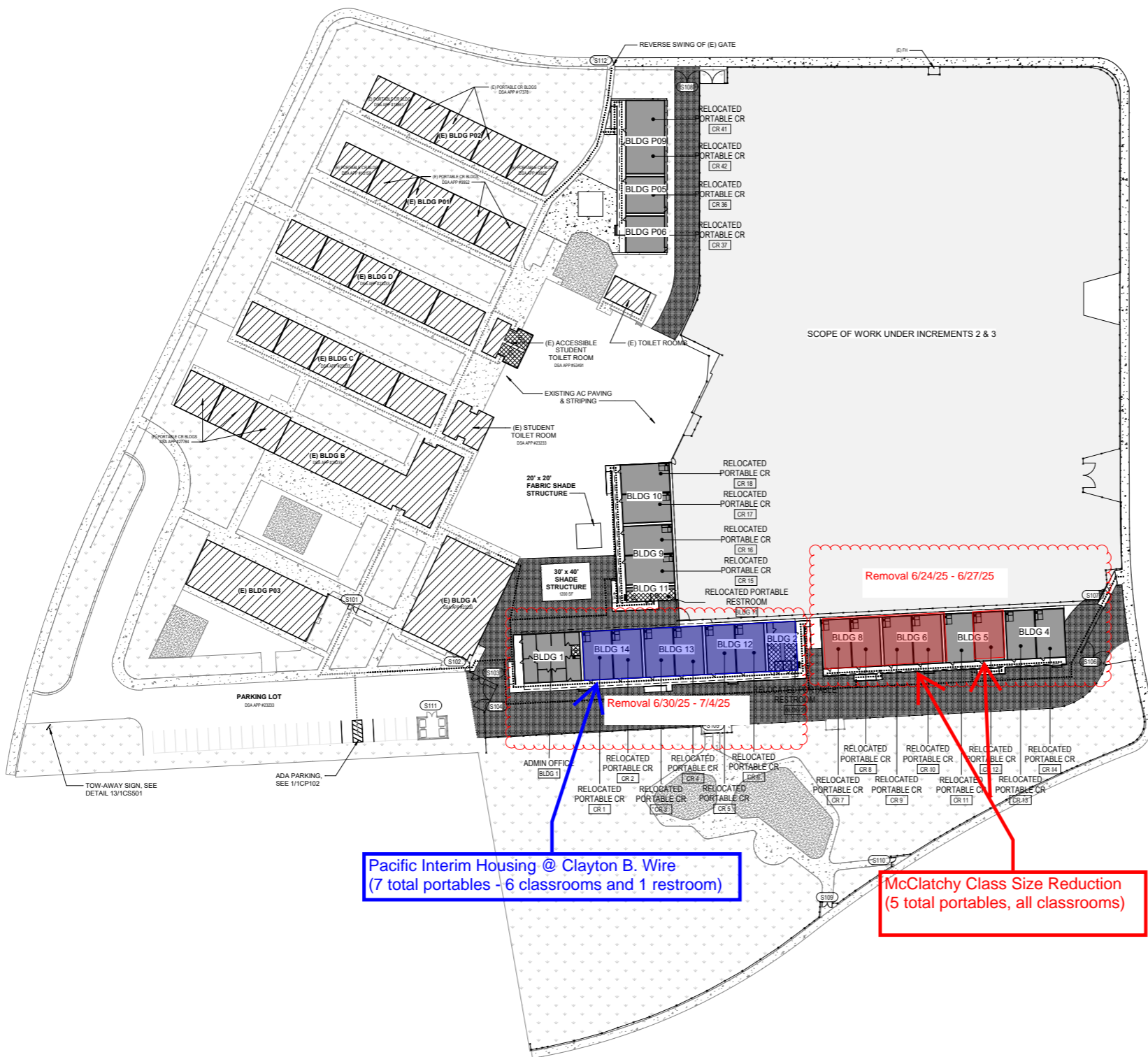

GENERAL NOTES

- 1. ACCESSIBLE ROUTE COMPONENTS INCLUDE BUT ARE NOT LIMITED TO**
- AT LEAST 48" IN WIDTH OR AS APPROVED BY CODE.
 - WITHOUT ABRUPT LEVEL CHANGES EXCEEDING 1/2" IF BEVELED AT 1:2 MAXIMUM SLOPE, OR VERTICAL LEVEL CHANGES EXCEEDING 1/4".
 - WITH A FIRM, STABLE, AND SLIP RESISTANT WALKING SURFACE.
 - WITH A RUNNING SLOPE OF 1:20 OR LESS.
 - WITH RUNNING SLOPE OF CODE COMPLIANT RAMPS, NOT TO EXCEED 8.33% (1:12). (RAMPS COMPLY WITH 119-405)
 - WITH REQUIRED LANDINGS AND LEVEL AREAS WITH A SLOPE OF 1:48 OR LESS.
 - WITH A CROSS SLOPE OF 1:48 OR LESS.
 - WITH OPENINGS IN DRAINS AND GRATING NOT TO EXCEED 1/2" IN PREDOMINANT DIRECTION OF TRAVEL.
 - IS FREE OF OVERHEAD OBSTRUCTIONS WITHIN 80" ABOVE THE WALKING SURFACE, AND IS FREE OF OBJECTS WHICH PROTRUDE MORE THAN 4" BETWEEN THE HEIGHTS OF 27" AND 80" ABOVE THE WALKING SURFACE.

LEGEND

- B: BOYS RESTROOM
- G: GIRLS RESTROOM
- U: UNISEX RESTROOM
- S: STAFF RESTROOM
- RESTROOM LOCATION
- ACCESSIBLE RESTROOM
- ACCESSIBILITY PATH OF TRAVEL
- (E) DSA APPROVED ACCESSIBILITY PATH OF TRAVEL
- PROPERTY LINE
- LIMITS OF ARCHITECTURAL SCOPE OF WORK
- (E) BUILDINGS WITH NO SCOPE OF WORK
- RELOCATED PORTABLES
- (E) AC PAVING
- AC PAVING
- EXISTING LANDSCAPE
- (E) DF EXISTING ACCESSIBLE HI-LO DRINKING FOUNTAIN

DESIGN PROFESSIONAL IN GENERAL RESPONSIBLE CHARGE STATEMENT: THE POT IDENTIFIED IN THESE CONSTRUCTION DOCUMENTS IS COMPLIANT WITH THE CURRENT APPLICABLE CALIFORNIA BUILDING CODE ACCESSIBILITY PROVISIONS FOR PATH OF TRAVEL REQUIREMENTS FOR ALTERATIONS, ADDITIONS AND STRUCTURAL REPAIRS. AS PART OF THE DESIGN OF THIS PROJECT, THE POT WAS EXAMINED AND ANY ELEMENTS, COMPONENTS OR PORTIONS OF THE POT THAT WERE DETERMINED TO BE NONCOMPLIANT 1) HAVE BEEN IDENTIFIED AND 2) THE CORRECTIVE WORK NECESSARY TO BRING THEM INTO COMPLIANCE HAS BEEN INCLUDED WITHIN THE SCOPE OF THIS PROJECT'S WORK THROUGH DETAILS, DRAWINGS AND SPECIFICATIONS INCORPORATED INTO THESE CONSTRUCTION DOCUMENTS. ANY NONCOMPLIANT ELEMENTS, COMPONENTS OR PORTIONS OF THE POT THAT WILL NOT BE CORRECTED BY THIS PROJECT BASED ON VALUATION THRESHOLD LIMITATIONS OR A FINDING OF UNREASONABLE HARDSHIP ARE SO INDICATED IN THESE CONSTRUCTION DOCUMENTS.

PARKING SUMMARY

STAFF / VISITOR PARKING						
	NON ACCESSIBLE SPACES	STANDARD REQUIRED	STANDARD PROVIDED	VAN SPACES REQUIRED	VAN SPACES PROVIDED	TOTAL
TOTAL	27	1	1	1	1	29

ACCESSIBLE PATH OF TRAVEL:
 ACCESSIBLE PATH OF TRAVEL AS INDICATED ON PLANS IS A BARRIER-FREE ACCESS ROUTE WITHOUT ANY ABRUPT LEVEL CHANGES EXCEEDING 1/2" IF BEVELED AT 1:2 MAXIMUM SLOPE OR VERTICAL LEVEL CHANGES EXCEEDING 1/4" MAXIMUM AND AT LEAST 48" IN WIDTH. SURFACE IS STABLE, FIRM AND SLIP-RESISTANT. CROSS SLOPE DOES NOT EXCEED 2% AND SLOPE IN THE DIRECTION OF TRAVEL IS LESS THAN 5% UNLESS OTHERWISE INDICATED. ACCESSIBLE PATH OF TRAVEL SHALL BE MAINTAINED FREE OF OVERHANGING OBSTRUCTIONS TO 80" MINIMUM AND PROTRUDING OBJECTS GREATER THAN 4" PROJECTION FROM WALL ABOVE 27" AND LESS THAN 80". ARCHITECT SHALL VERIFY THAT THERE ARE NO BARRIERS IN THE PATH OF TRAVEL.

DSA APP & PC # - MODULAR BLDGS

BLDG NO.	BLDG PRIMARY FUNCTION	OCCUPANCY GROUP	DSA PC NUMBER	DSA APPLICATION NUMBER
BLDG 1	ADMIN OFFICE	GROUP B	02-101487	02-103351
BLDG 2	RELOCATED PORTABLE RESTROOM	GROUP E	02-101487	02-103351
BLDG 11	RELOCATED PORTABLE RESTROOM	GROUP E	02-101487	02-103351
CR 1	RELOCATED PORTABLE CR	GROUP E	02-101487	02-103351
CR 2	RELOCATED PORTABLE CR	GROUP E	02-101487	02-103351
CR 3	RELOCATED PORTABLE CR	GROUP E	02-101487	02-103351
CR 4	RELOCATED PORTABLE CR	GROUP E	02-101487	02-103351
CR 5	RELOCATED PORTABLE CR	GROUP E	02-101487	02-103351
CR 7	RELOCATED PORTABLE CR	GROUP E	02-101487	02-103351
CR 8	RELOCATED PORTABLE CR	GROUP E	02-101487	02-103351
CR 9	RELOCATED PORTABLE CR	GROUP E	02-101487	02-103351
CR 10	RELOCATED PORTABLE CR	GROUP E	02-101487	02-103351
CR 11	RELOCATED PORTABLE CR	GROUP E	02-101487	02-103351
CR 12	RELOCATED PORTABLE CR	GROUP E	02-101487	02-103351
CR 13	RELOCATED PORTABLE CR	GROUP E	02-101487	02-103351
CR 14	RELOCATED PORTABLE CR	GROUP E	02-101487	02-103351
CR 15	RELOCATED PORTABLE CR	GROUP E	02-101487	02-103351
CR 16	RELOCATED PORTABLE CR	GROUP E	02-101487	02-103351
CR 17	RELOCATED PORTABLE CR	GROUP E	02-101487	02-103351
CR 18	RELOCATED PORTABLE CR	GROUP E	02-101487	02-103351
CR 36	RELOCATED PORTABLE CR	GROUP E	PC 87	53491
CR 37	RELOCATED PORTABLE CR	GROUP E	PC 87	53491
CR 41	RELOCATED PORTABLE CR	GROUP E	PC 296	101090
CR 42	RELOCATED PORTABLE CR	GROUP E	PC 296	101090

IDENTIFICATION STAMP
 DIV. OF THE STATE ARCHITECT
 APP: 02-120693 INC: 01
 REVIEWED FOR
 SS FLS ACS
 DATE: 03/06/2023

LIONAKIS
 2025 Nineteenth Street
 Sacramento, CA 95818
 P. 916.558.1900
 www.lionakis.com

CONSULTANT

SEAL

PROJECT
**KEMBLE-CHAVEZ
 ELEMENTARY SCHOOL -
 PORTABLE RELOCATION
 INCREMENT 1**
 7495 29TH ST
 SACRAMENTO, CA 95822

CLIENT
 SACRAMENTO CITY UNIFIED SCHOOL
 DISTRICT
 5735 47TH AVE, SACRAMENTO CA 95824

ISSUED

MARK	DATE	DESCRIPTION
	02/06/2023	QC & CONSTRUCTION REVISIONS
	02/27/2023	100% CD DSA APPROVAL

MANAGEMENT

LIONAKIS PROJECT NO:	022063
CLIENT PROJECT NO:	200.00.007
COPYRIGHT:	LIONAKIS 2021

TITLE
**SITE PLAN -
 ACCESSIBILITY**

SHEET
1GA102



0. 1/4" = 12'

IF THIS SHEET IS NOT 30"x42" IT IS A REDUCED PRINT. SCALE ACCORDINGLY.

C

B

\\sacred\docs\024171\CLAYTON B WIRE ESD04171_ARCH\MECH_R24_CENTRAL.rvt

1/16/2024 1:31:07 PM

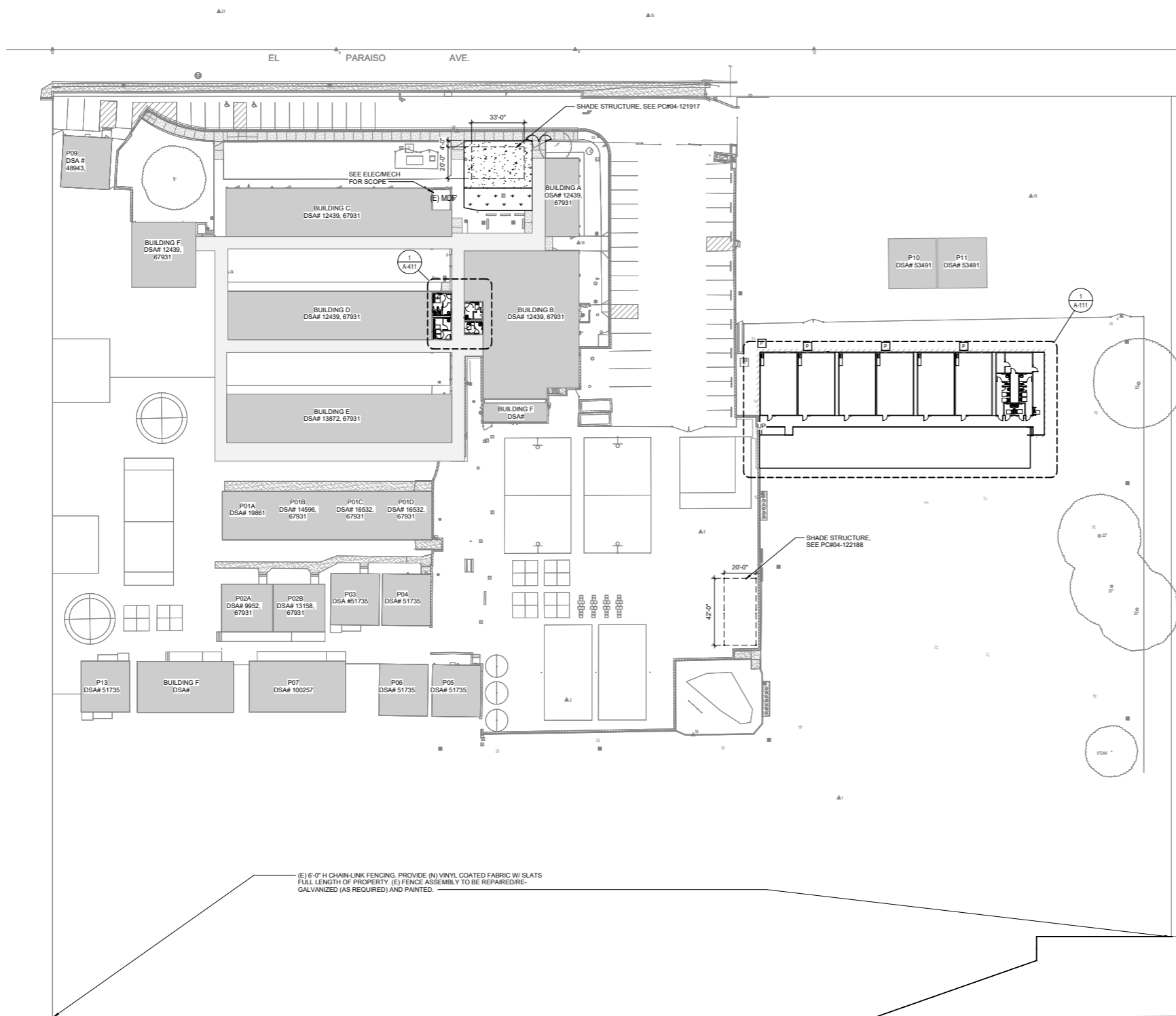

1 SITE PLAN - OVERALL
SCALE: 1" = 30'-0"

GENERAL NOTES

- SEE CIVIL DRAWINGS FOR:
 - ALL ASPHALTIC AND PORTLAND CEMENT CONCRETE PAVING TYPES AND SECTIONS
 - ALL UNDERGROUND UTILITY LOCATIONS INCLUDING SANITARY SEWER AND WATER LINE EXTENSIONS WITH POCS
 - HORIZONTAL CONTROL PLAN FOR DIMENSIONS NOT OTHERWISE SHOWN ON THIS SITE PLAN DRAWING
 - TYPICAL PAVEMENT STRIPING, SYMBOLS, ETC. UNO
 - ADA WALKWAYS, RAMPS, DROP-OFF AREAS, PARKING LOT STRIPING, SIGNAGE AND CURB MARKINGS
- SEE ELECTRICAL / LOW VOLTAGE DRAWINGS FOR:
 - LOCATION AND TYPES OF VARIOUS POWER AND SIGNAL PULL BOXES
 - LOCATION OF ALL SITE LIGHT FIXTURES
- SEE PLUMBING DRAWINGS FOR:
 - ROUTING OF ALL UNDERGROUND GAS LINES
 - POINT OF CONNECTIONS FOR ALL WATER AND SEWER UTILITIES FROM CIVIL DRAWINGS
- SEE DRAWING GA101 FOR ACCESSIBLE PATH OF TRAVEL IMPROVEMENTS.
- SEE DRAWING **GL101** FOR ALL EMERGENCY VEHICLE ACCESS AND HYDRANTS.
- PROVIDE 12" CONCRETE MOW STRIP BETWEEN ALL LANDSCAPE AREAS AND BUILDINGS, UNO.
- OUTSIDE CORNERS OF ALL BUILDINGS SHALL HAVE A CONCRETE EXPANSION JOINT.
- ALL FENCING CALLOUTS ARE FROM END TO END, UNO.
- LOCATE TOW AWAY SIGNAGE AT EACH PARKING LOT ENTRANCE, SEE **G-3000**.
- CONTRACTOR TO FIELD VERIFY SPOT ELEVATION PRIOR TO SETTING FINAL GRADES.
- THE GROUND AROUND THE BUILDING SHALL BE SLOPE A MINIMUM OF 5% AWAY FROM THE BUILDING FOR AT LEAST 10 FEET FROM THE FACE OF THE WALL PER CBC, AND IMPERVIOUS SURFACES SHALL BE SLOPED AT A MINIMUM OF 2% AWAY FROM THE BUILDING. REFER TO CIVIL DRAWINGS FOR SLOPE AND SPOT ELEVATIONS.
- CONTRACTOR TO PROVIDE AND COORDINATE "KNOX BOX" INSTALLATION LOCATIONS PER LOCAL FIRE DEPARTMENT.

SITE LEGEND

- PROPERTY LINE
- - - LIMITS OF ARCHITECTURAL SCOPE OF WORK
- [Solid Grey Box] EXISTING BUILDING WITH NO SCOPE OF WORK
- [Cross-hatched Box] EXISTING BUILDING WITH MODERNIZATION WORK
- (G101) SITE GATES - SEE GATE SCHEDULE ON **XX-XXX**
- [Dashed Line] DECORATIVE FENCING, SEE [Symbol]
- [Solid Line] CHAIN LINK FENCING, SEE [Symbol]

LIONAKIS

2025 Nineteenth Street
Sacramento, CA 95818
P 916.558.1900
www.lionakis.com

CONSULTANT

FOR REVIEW ONLY / NOT FOR CONSTRUCTION
THE CONSTRUCTION DOCUMENTS HAVE NOT BEEN APPROVED BY THE ENFORCEMENT AGENCY AND ARE NOT COMPLETE OR READY FOR CONSTRUCTION. ELEMENTS, MEMBERS, SYSTEMS AND ASSOCIATED DETAILS AND SPECIFICATIONS MAY NOT BE SHOWN OR FULLY DEVELOPED. FOR BIDDING/ESTIMATING PURPOSES, UTILIZE ADDITIONAL MATERIALS AND QUANTITIES TO ACCOUNT FOR THOSE ITEMS NOT SHOWN OR FULLY DEVELOPED.

SEAL



PROJECT
C.B. WIRE PORTABLE RELOCATION & RESTROOM UPGRADES

5100 EL PARAISO AVE,
SACRAMENTO, CA 95824

CLIENT
SACRAMENTO CITY UNIFIED SCHOOL DISTRICT
425 1ST AVENUE, SACRAMENTO CA 95818

ISSUED

MARK	DATE	DESCRIPTION

MANAGEMENT

LIONAKIS PROJECT NO.	024171
CLIENT PROJECT NO.	
COPYRIGHT:	LIONAKIS 2017

TITLE

OVERALL SITE PLAN

SHEET

AS101

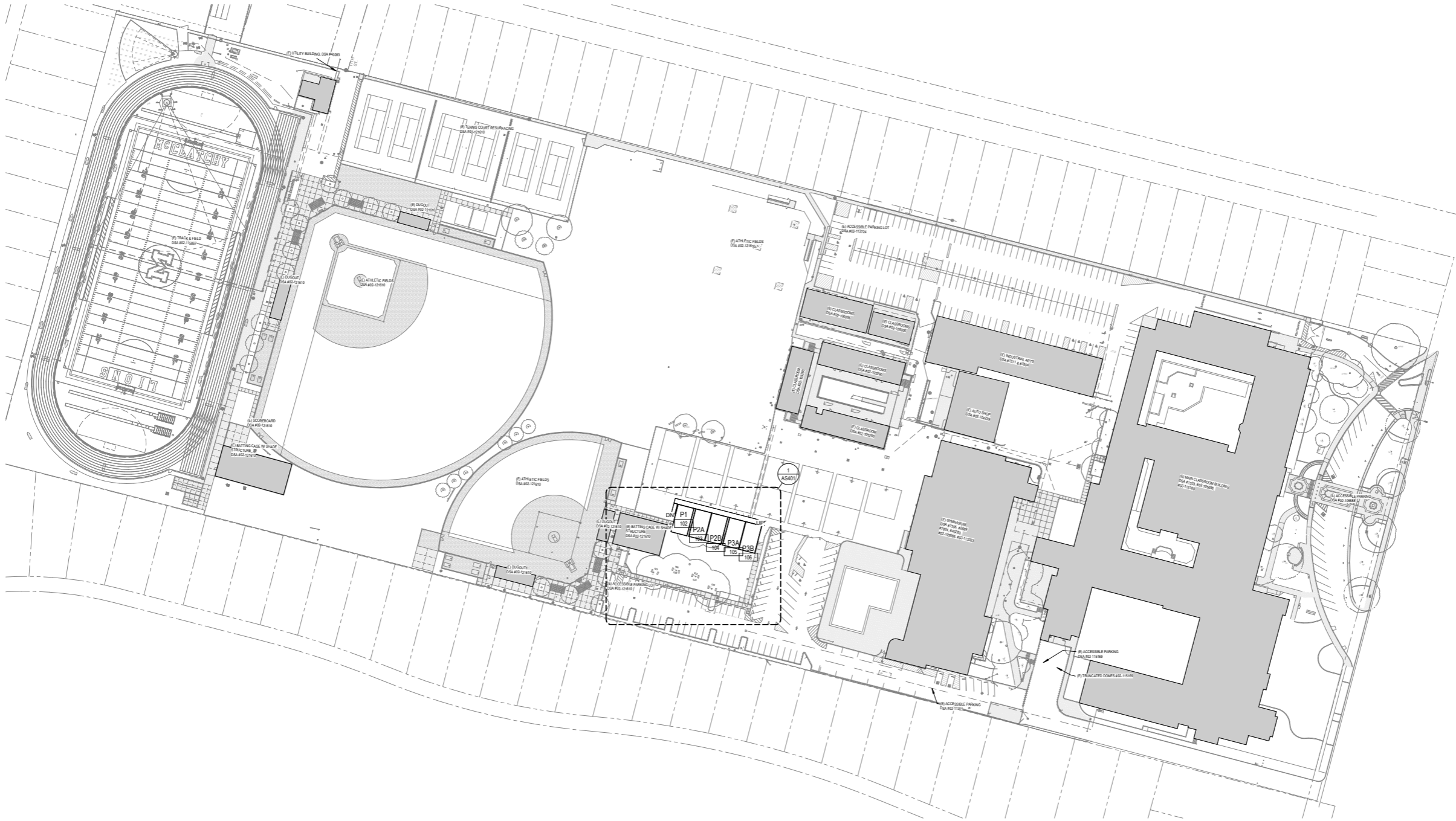

1 OVERALL SITE PLAN

SCALE 1" = 60'-0"

FOR REVIEW ONLY / NOT FOR CONSTRUCTION
THE CONSTRUCTION DOCUMENTS HAVE NOT BEEN APPROVED BY THE ENFORCEMENT AGENCY AND ARE NOT COMPLETE OR READY FOR CONSTRUCTION. ELEMENTS, MATERIALS, SYSTEMS AND ASSOCIATED DETAILS AND SPECIFICATIONS MAY NOT BE SHOWN OR FULLY DEVELOPED. FOR BIDDING/ESTIMATING PURPOSES, UTILIZE ADDITIONAL MATERIALS AND QUANTITIES TO ACCOUNT FOR THOSE ITEMS NOT SHOWN OR FULLY DEVELOPED.

SEAL

PROJECT
C.K. MCCLATCHY HIGH SCHOOL PORTABLE RELOCATION

3066 FREEPORTE BLVD,
SACRAMENTO, CA 95818

CLIENT
SACRAMENTO CITY UNIFIED SCHOOL DISTRICT
425 1ST AVE, SACRAMENTO, CA 95818.

ISSUED

MARK	DATE	DESCRIPTION
------	------	-------------

MANAGEMENT

DESCRIPTION	NO.
LIONAKIS PROJECT NO.	024203
CLIENT PROJECT NO.	
COPYRIGHT:	LIONAKIS 2017

TITLE
OVERALL SITE PLAN

SHEET
AS101