

0. 1/4" = 1' - 0"  
 IF THIS SHEET IS NOT 30"x42" IT IS A REDUCED PRINT. SCALE ACCORDINGLY.  
 C:\Users\mccord\OneDrive\Documents\Revit\Local\18179\_BM\_A\MASTER\_R18\_CENTRAL\_Unrevised.rvt  
 10/10/2019 10:06:50 AM

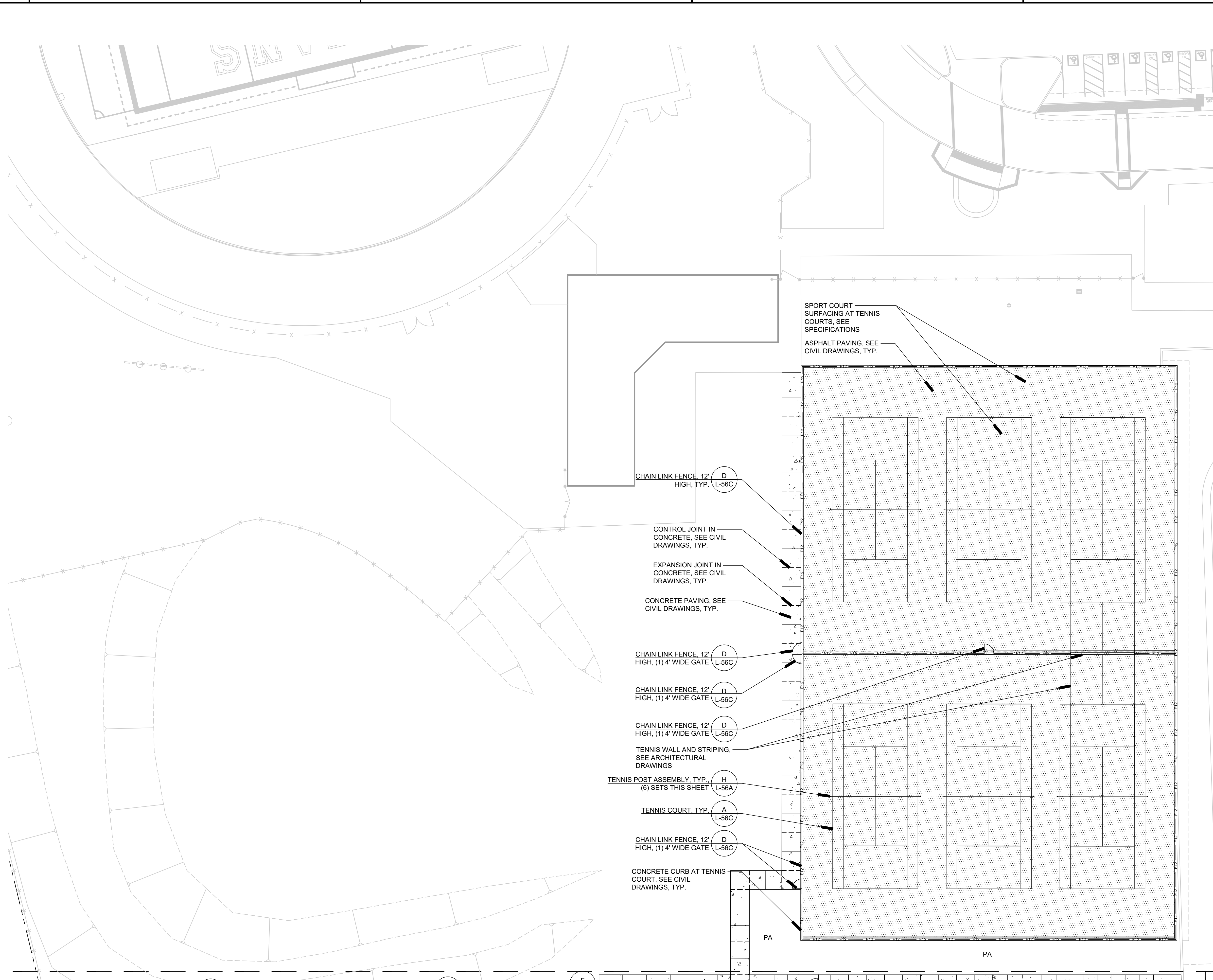

**NOTE:**  
 EXISTING TENNIS COURTS CANNOT BE DEMOLISHED UNTIL AFTER MAY 1, 2024, OR UNTIL NEW ONES ARE READY.

**MATERIAL AND DETAIL REFERENCE NOTES**

- THESE NOTES ARE FOR GENERAL REFERENCE IN CONJUNCTION WITH AND AS A SUPPLEMENT TO THE WRITTEN SPECIFICATIONS, DETAILS, ADDENDA AND CHANGE ORDERS ASSOCIATED WITH THE CONTRACT DOCUMENTS.
- CONTRACTOR SHALL BECOME FAMILIAR WITH THE LOCATION OF EXISTING AND PROPOSED UNDERGROUND SERVICES. CONTACT UNDERGROUND SERVICE ALERT (USA) AT (800) 642-2444 PRIOR TO BEGINNING WORK. CONTACT OWNER'S REPRESENTATIVE SHOULD ANY CONFLICTS ARISE.
- SCORE AND EXPANSION JOINTS SHALL BE LOCATED AS INDICATED ON THIS PLAN. CONTRACTOR SHALL MAKE MINOR ADJUSTMENTS WHEN NECESSARY TO ALIGN SCORE AND EXPANSION JOINTS WITH RELATIVE ELEMENTS AS SHOWN ON THE PLAN.
- DETAIL CALLOUTS ON PLAN ARE PROVIDED FOR CONVENIENCE AND GENERAL REFERENCE ONLY. CONTRACTOR SHALL PROVIDE QUANTITY OF PRODUCTS, ELEMENTS AND MATERIALS AS SYMBOLIZED ON PLANS, ASSOCIATED DETAILS, AND SPECIFICATIONS.
- FOR EACH CONCRETE COLOR AND FINISH SPECIFIED, CONTRACTOR SHALL POUR A 2'x2' SAMPLE FOR APPROVAL BY OWNER'S REPRESENTATIVE PRIOR TO INSTALLING CONCRETE PAVING.
- LANDSCAPE ARCHITECT IS NOT RESPONSIBLE FOR MEANS AND METHODS OF CONSTRUCTION. IF WORK WITHIN THIS SCOPE REQUIRES REMOVAL, RELOCATION, OR DEMOLITION OF EXISTING TO REMAIN IMPROVEMENTS, BOTH SURFACE AND KNOWN SUBSURFACE CONDITIONS, CONTRACTOR SHALL INCLUDE IN THE BID SUFFICIENT LABOR AND MATERIALS TO RESTORE EXISTING TO REMAIN IMPROVEMENTS IN KIND AND AS ACCEPTABLE TO OWNER'S REPRESENTATIVE.
- CONTRACTOR SHALL COORDINATE ROUGH GRADING AND FINE GRADING TO ENSURE EXISTING SUITABLE TOPSOIL IS REMOVED, STOCKPILED AND REINSTALLED INTO ALL PROPOSED LANDSCAPE AREAS PER LANDSCAPE SPECIFICATION SECTION 32 90 00. IN THE EVENT THERE IS NOT ENOUGH EXISTING TOPSOIL, OR NO PLACE TO STOCKPILE TOPSOIL, CONTRACTOR SHALL IMPORT AND INSTALL TOPSOIL PER LANDSCAPE SPECIFICATION SECTION 32 90 00.
- THE CONTRACTOR SHALL BE RESPONSIBLE UNDER THIS CONTRACT FOR REPAIRING OR REPLACING, AT THEIR OWN EXPENSE, SURFACE AND SUBSURFACE SITE FEATURES TO REMAIN, INCLUDING BUT NOT LIMITED TO ANY STRUCTURES, FENCES, WALLS, PAVING SURFACES, PLANT MATERIAL AND/OR TREES DAMAGED OR DESTROYED, BOTH ON THIS PROPERTY OR THOSE PROPERTIES ADJACENT TO THIS SITE. THE DAMAGED ITEM(S) WILL BE RESTORED TO THEIR ORIGINAL CONDITION OR REPLACED TO THE SATISFACTION OF THE OWNER'S REPRESENTATIVE.
- LANDSCAPE ARCHITECT IS NOT RESPONSIBLE FOR ROOFTOP GARDEN LINER, BUILDING WATERPROOFING, DRAINAGE FROM ROOF, WEIGHT LOAD BEARING ISSUES, MAINTENANCE, SAFETY, AND MEANS AND/OR METHODS OF INSTALLATION.
- CONTRACTOR SHALL ADJUST EXISTING UTILITY BOXES TO BE FLUSH WITH PROPOSED GRADES.
- REFER TO THE FOLLOWING SPECIFICATION SECTIONS:  
 05 52 00 METAL RAILINGS  
 12 93 00 SITE FURNISHINGS  
 31 13 16 TREE PROTECTION  
 32 12 33.1 SPORT COURT SURFACING  
 32 14 40 CRUSHED STONE SURFACING  
 32 31 13 CHAIN LINK FENCES  
 32 18 13 SYNTHETIC GRASS SURFACING
- REFER TO CONSTRUCTION DETAILS ON SHEETS L-56A THROUGH L-56E.

**MATERIALS & DETAIL REFERENCE LEGEND**

SYMBOL	DESCRIPTION	DETAIL
[Pattern]	CONCRETE PAVING. SEE CIVIL DRAWINGS, TYP.	-
[Pattern]	AC PAVING. SEE CIVIL DRAWINGS, TYP. SPORT COURT SURFACING. FIELD OF PLAY COLOR TO BE SELECTED BY OWNER'S REPRESENTATIVE AND A CONTRASTING OUTER COURT COLOR SHALL BE SELECTED BY OWNER'S REPRESENTATIVE. GAMES LINES TO BE WHITE.	-
[Symbol]	HANDRAIL AT STEPS, IN STEPS	A, L-56A
[Symbol]	CHAIN LINK FENCE, 6' HIGH	B, L-56C
[Symbol]	CHAIN LINK FENCE, 8' HIGH	F, L-56C
[Symbol]	CHAIN LINK FENCE, 12' HIGH	D, L-56C
[Symbol]	CHAIN LINK FENCE, 16' HIGH	A, L-56D
[Symbol]	CHAIN LINK FENCE, 30' HIGH	A, L-56E
[Symbol]	22' PROTECTIVE NETTING OVER 8' TALL CHAIN LINK FENCE	D, E, L-56F
[Symbol]	22' PROTECTIVE NETTING OVER DUGOUT	D, E, L-56F
[Symbol]	GUARD RAIL SYSTEM	F, L-56F
[Symbol]	BASES	A, L-56B
[Symbol]	1ST BASE AT SOFTBALL FIELD	A, L-56B
[Symbol]	PITCHER'S RUBBER	C, L-56B
[Symbol]	HOME PLATE	B, L-56B
[Symbol]	CLAY BRICKS	B, C, E, L-56B
[Symbol]	FOUL POLE	C, L-56A
[Symbol]	FLAG POLE	B, L-56A
[Symbol]	SYNTHETIC TURF	H, L-56B
[Symbol]	INFIELD FINES	F, L-56B
[Symbol]	WARNING TRACK FINES	I, L-56B
[Symbol]	STABILIZED FINES AT PAVING	G, L-56B
[Symbol]	PLANTING AREA. SEE PLANTING AND IRRIGATION DRAWINGS	-
[Symbol]	PLAYER'S BENCH	D, L-56A
[Symbol]	BLEACHERS	C, L-56E
[Symbol]	SCORER'S TABLE PER SPECIFICATIONS	-
[Symbol]	BAT STORAGE	E, L-56A

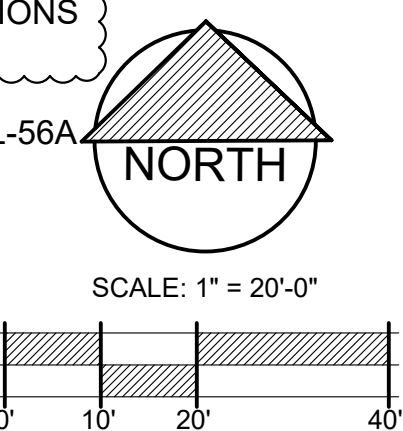

**LIONAKIS**

2025 Nineteenth Street  
 Sacramento CA 95818  
 P 916.558.1900  
 www.lionakis.com



1723 Hamilton Ave, Suite 101  
 San Jose, CA 95125  
 T. 408.292.2196  
 www.anla-associates.com

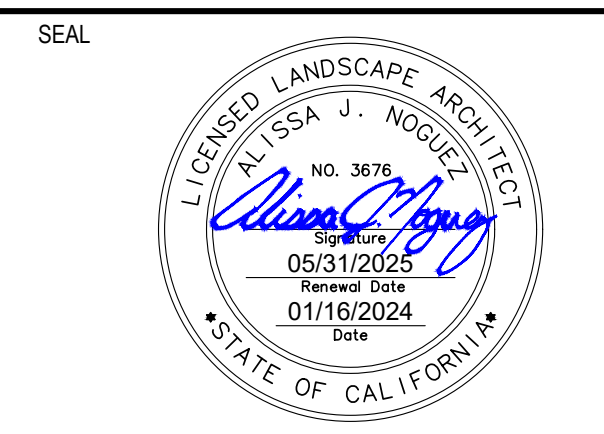

**PROJECT**  
 LUTHER BURBANK HIGH SCHOOL  
 ATHLETIC FIELDS REPLACEMENT

3500 FLORIN ROAD  
 SACRAMENTO, CA 95823

**CLIENT**  
 SACRAMENTO CITY UNIFIED SCHOOL DISTRICT  
 5735 47TH AVENUE, SACRAMENTO, CA 95824

**ISSUED**

MARK	DATE	DESCRIPTION
-	08.10.2023	DSA INITIAL SUBMITTAL
-	12.07.2023	DSA BACKCHECK
-	01.16.2024	ADDENDUM

**MANAGEMENT**  
 LIONAKIS PROJECT NO. \_\_\_\_\_  
 CLIENT PROJECT NO. \_\_\_\_\_  
 COPYRIGHT: \_\_\_\_\_

**AGENCY**

**TITLE**  
 MATERIALS AND  
 DETAIL  
 REFERENCE  
 PLAN

**SHEET**  
 LS16A

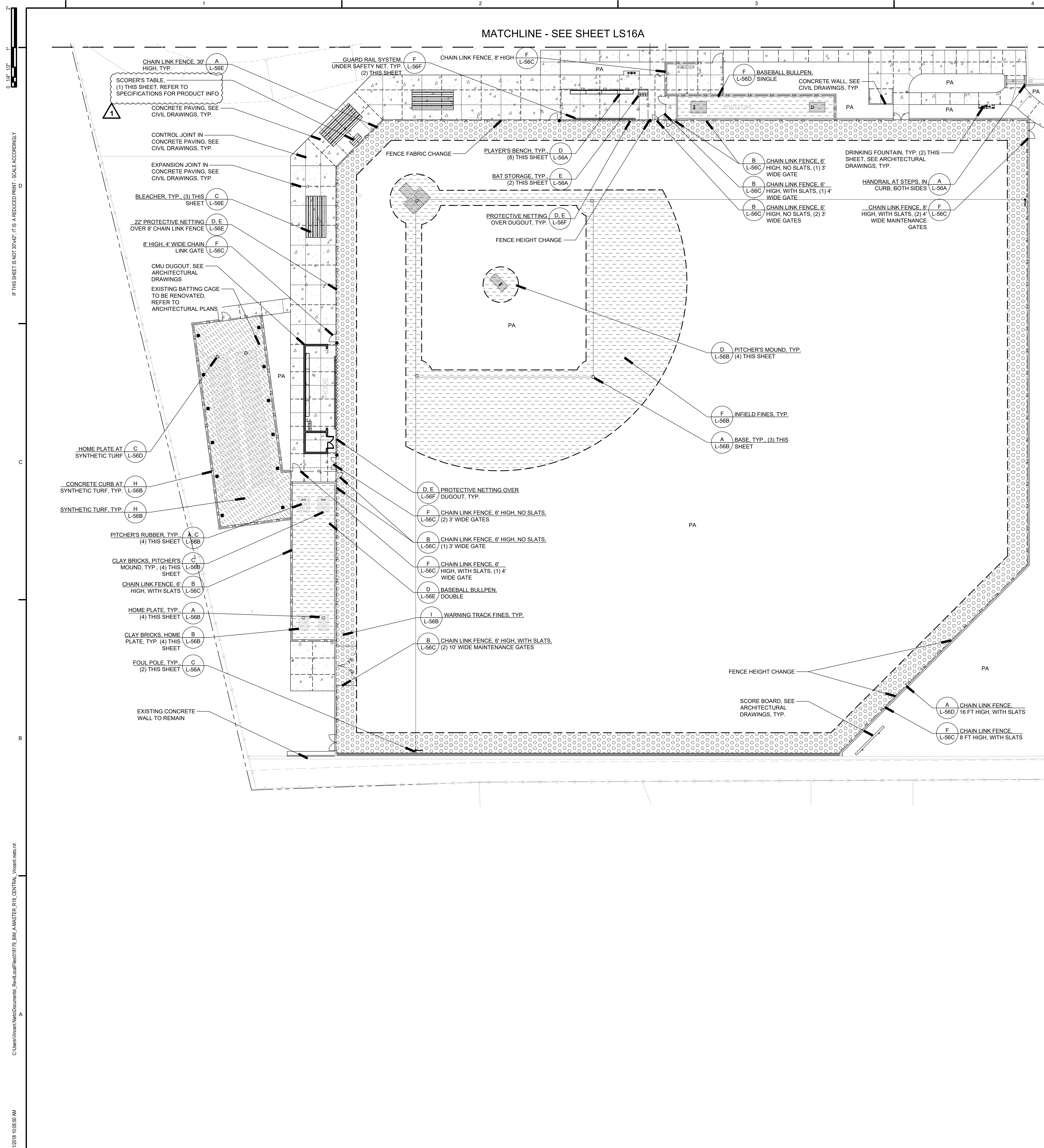

SEE SHEET LS16A FOR MATERIAL AND  
DETAIL REFERENCE NOTES LEGEND

**LIONAKIS**

2025 Nineteenth Street  
Sacramento CA 95818  
P 916.558.1900  
www.lionakis.com

CONSULTANT



1723 Hamilton Ave, Suite 101  
San Jose, CA 95125  
T. 408.292.2196  
www.anla-associates.com

SEAL

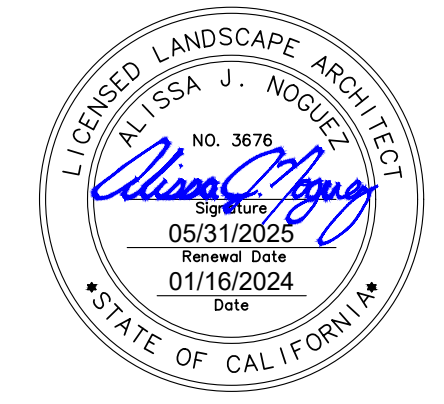

PROJECT  
**LUTHER BURBANK HIGH SCHOOL  
ATHLETIC FIELDS REPLACEMENT**

3500 FLORIN ROAD  
SACRAMENTO, CA 95823

CLIENT  
SACRAMENTO CITY UNIFIED SCHOOL DISTRICT  
5735 47TH AVENUE, SACRAMENTO, CA 95824

MARK	DATE	DESCRIPTION
-	08.10.2023	DSA INITIAL SUBMITTAL
-	12.07.2023	DSA BACKCHECK
-	01.16.2024	ADDENDUM

MANAGEMENT  
LIONAKIS PROJECT NO.:  
CLIENT PROJECT NO.:  
COPYRIGHT:  
AGENCY:

TITLE  
**MATERIALS AND  
DETAIL  
REFERENCE  
PLAN**

SHEET

**LS16B**

ANLA PROJECT NO.:

2318

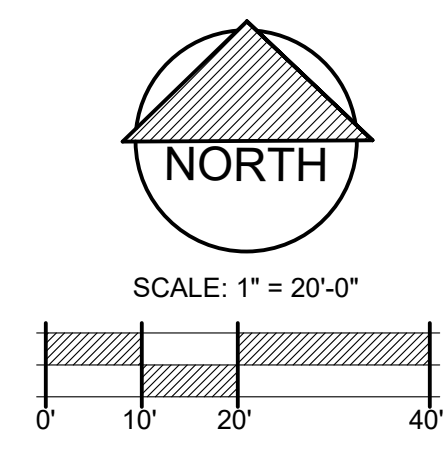

10/10/2019 10:06:50 AM C:\Users\mccent\OneDrive\Documents\Revit\Local\1818179\_BM\_A\MASTER\_R18\_CENTRAL\_Unshared.rvt

MATCHLINE - SEE SHEET LS16A

SEE SHEET LS16A FOR MATERIAL AND  
DETAIL REFERENCE NOTES LEGEND

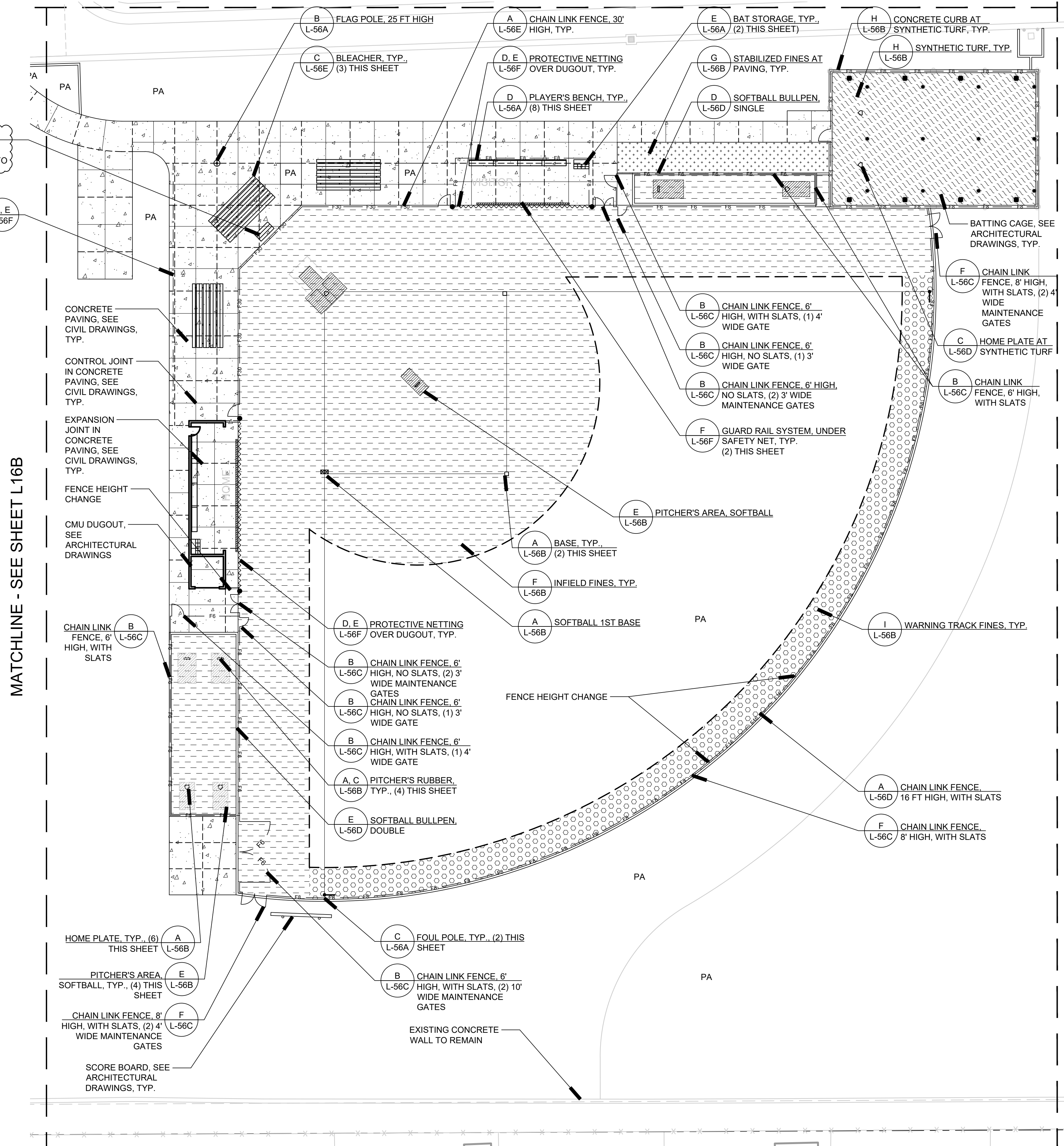

MATCHLINE - SEE SHEET L16B

SCORER'S TABLE  
(1) THIS SHEET. REFER TO  
SPECIFICATIONS FOR PRODUCT INFO

22' PROTECTIVE NETTING OVER  
8' TALL CHAIN LINK FENCE

IF THIS SHEET IS NOT 30"x42" IT IS A REDUCED PRINT. SCALE ACCORDINGLY.

C

B

C:\Users\lironakis\OneDrive\Documents\Revit\Local\16179\_BM\_MASTER\_R16\_CENTRAL\_Unrevised.rvt

10/10/2019 10:06:50 AM

LIONAKIS

2025 Nineteenth Street  
Sacramento CA 95818  
P 916.558.1900  
www.lionakis.com

CONSULTANT



1723 Hamilton Ave, Suite 101  
San Jose, CA 95125  
T. 408.292.2196  
www.anla-associates.com

SEAL

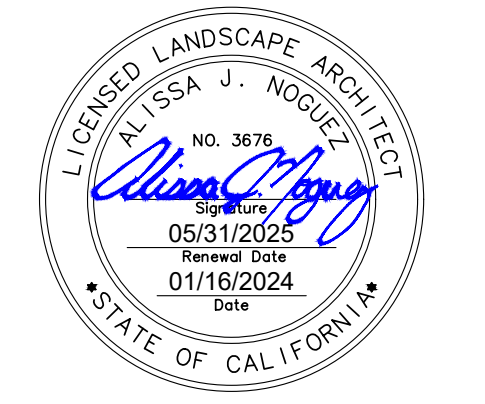

PROJECT  
LUTHER BURBANK HIGH SCHOOL  
ATHLETIC FIELDS REPLACEMENT

3500 FLORIN ROAD  
SACRAMENTO, CA 95823

CLIENT  
SACRAMENTO CITY UNIFIED SCHOOL DISTRICT  
5735 47TH AVENUE, SACRAMENTO, CA 95824

ISSUED

MARK	DATE	DESCRIPTION
-	08.10.2023	DSA INITIAL SUBMITTAL
-	12.07.2023	DSA BACKCHECK
-	01.16.2024	ADDENDUM

MANAGEMENT

LIONAKIS PROJECT NO. \_\_\_\_\_  
CLIENT PROJECT NO. \_\_\_\_\_  
COPYRIGHT: \_\_\_\_\_

AGENCY

TITLE  
MATERIALS AND  
DETAIL  
REFERENCE  
PLAN

SHEET

LS16C

ANLA PROJECT NO.

2318

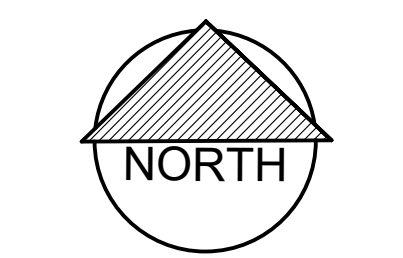

SCALE: 1" = 20'-0"

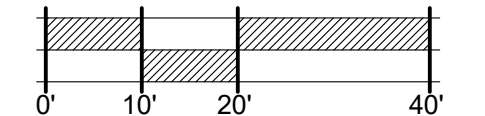

IF THIS SHEET IS NOT 30x42 IT IS A REDUCED PRINT - SCALE ACCORDINGLY

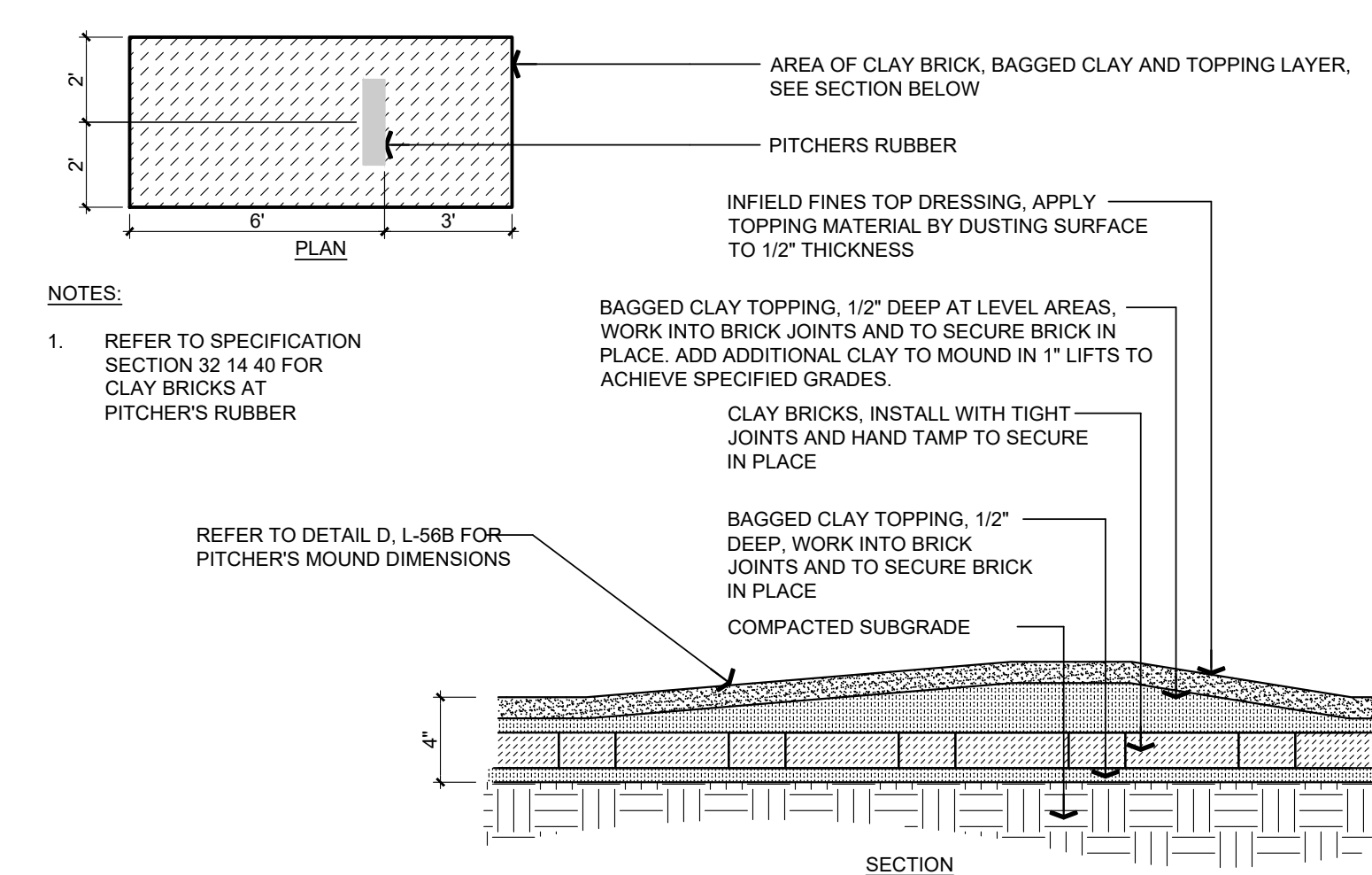
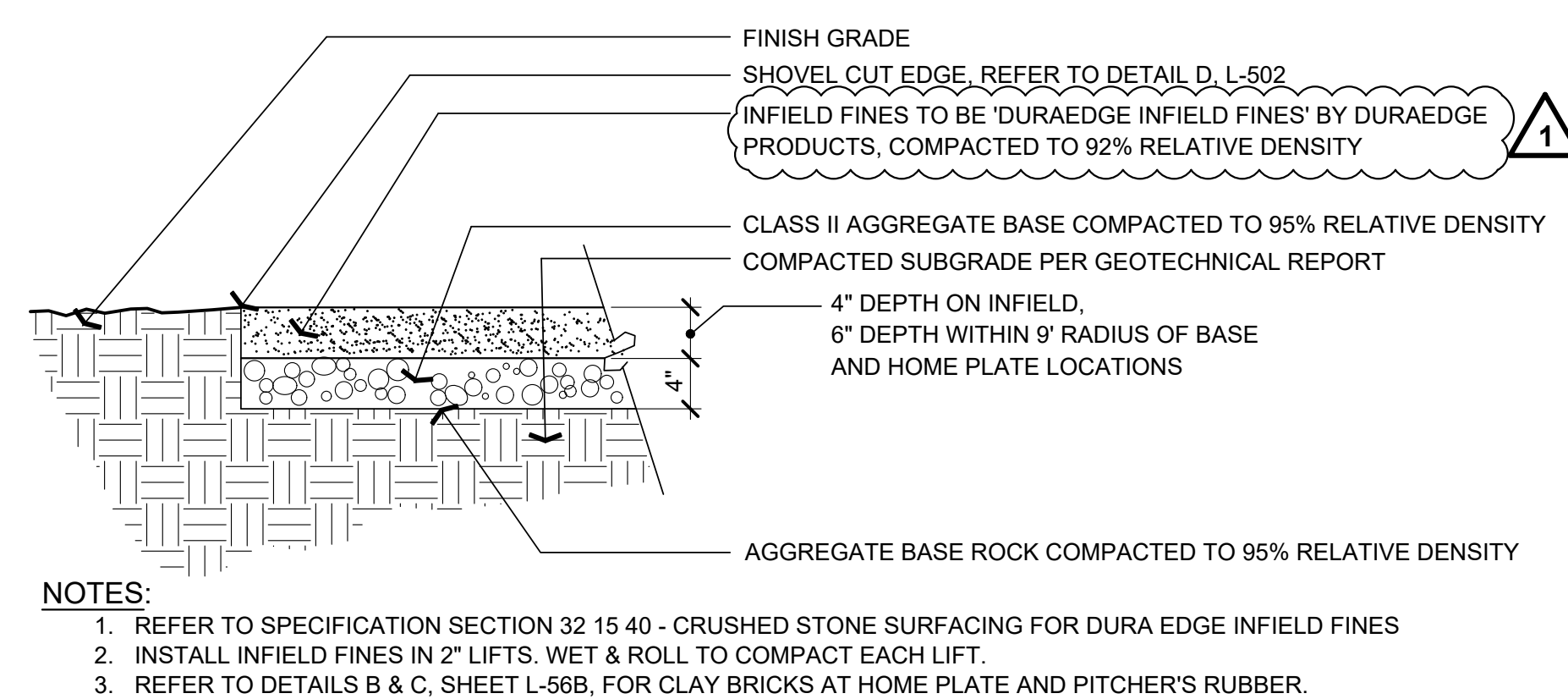
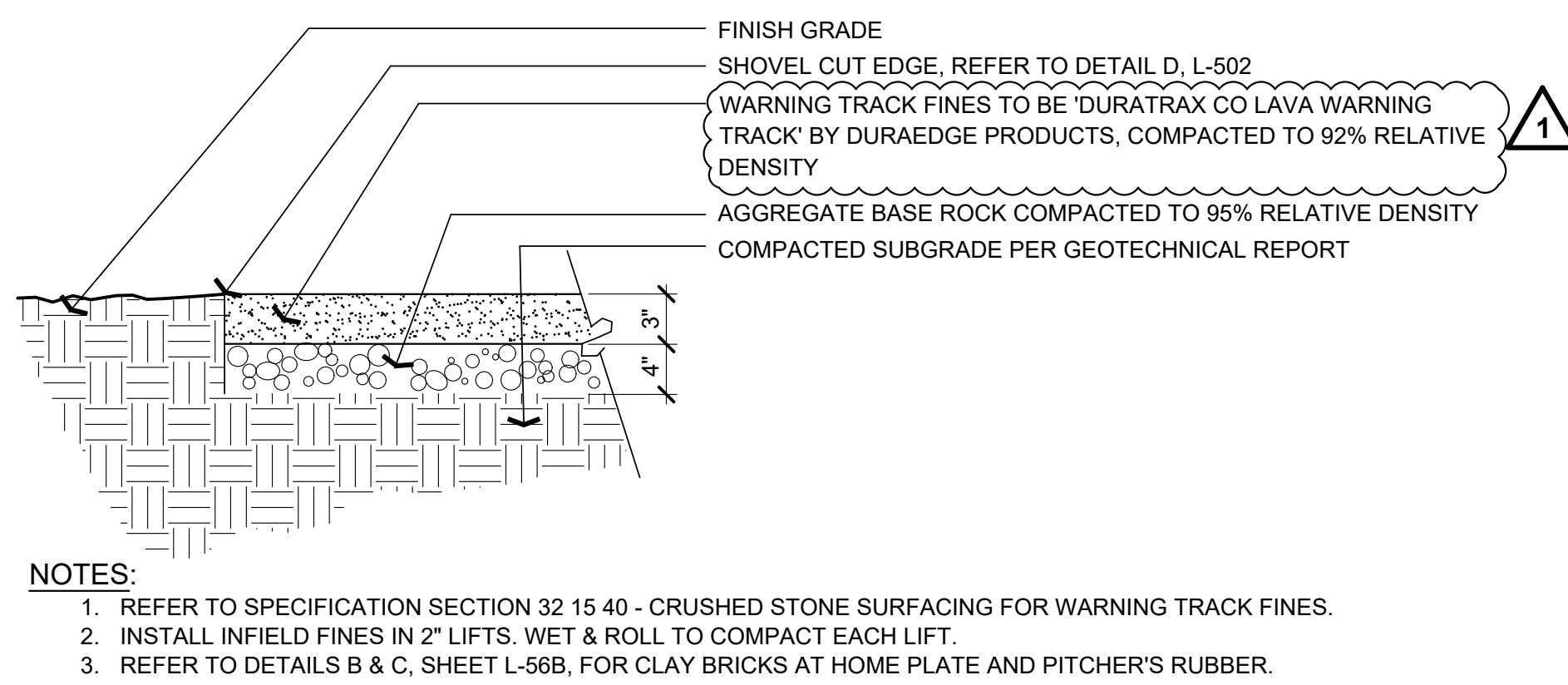

**I WARNING TRACK FINES**

SCALE: NTS

**F INFELD FINES**

SCALE: NTS

**C CLAY BRICKS, PITCHER'S RUBBER**

SCALE: NTS

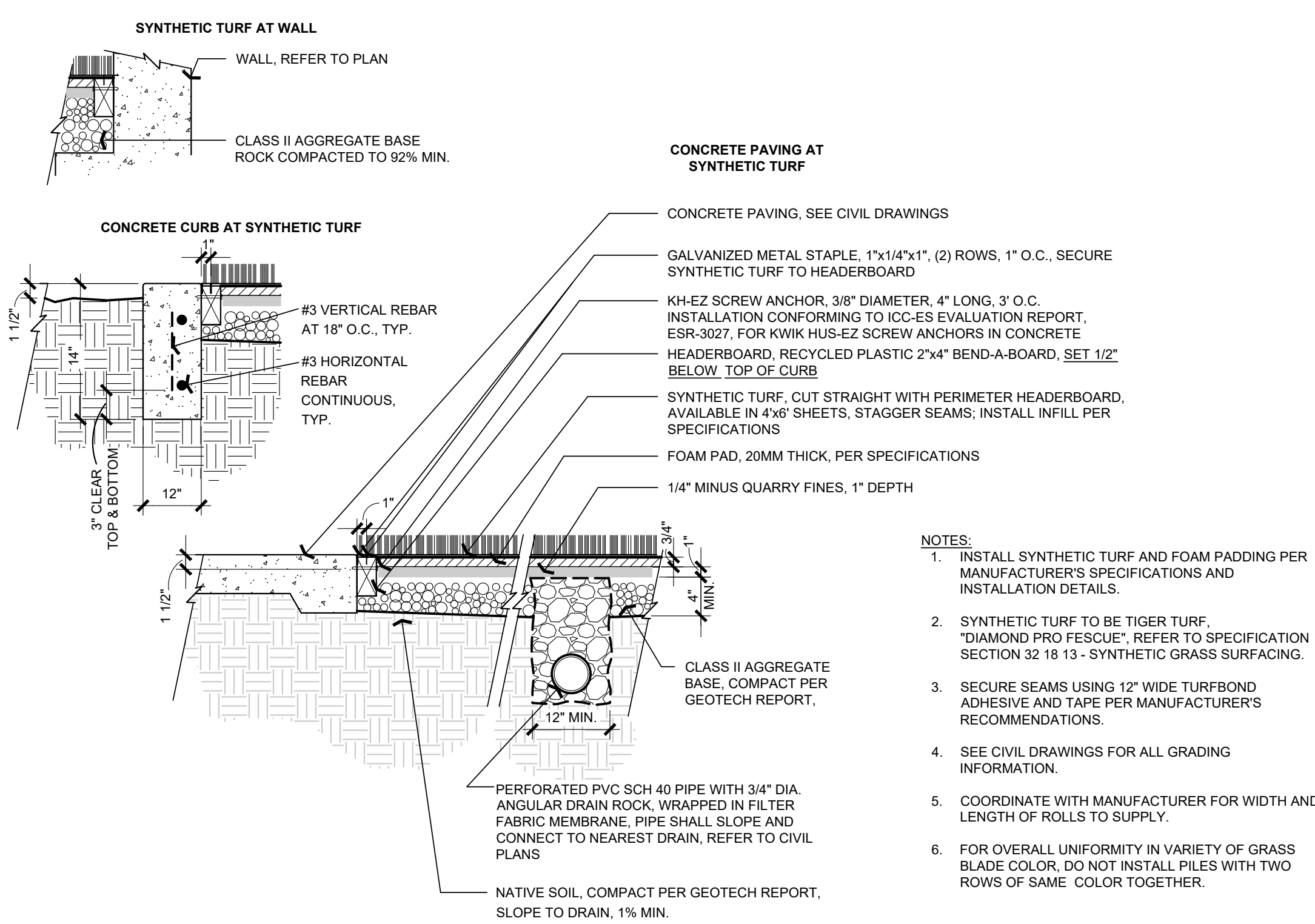

**H SYNTHETIC TURF**

SCALE: NTS

**E PITCHER'S AREA, SOFTBALL**

SCALE: NTS

**B CLAY BRICKS, HOME PLATE**

SCALE: NTS

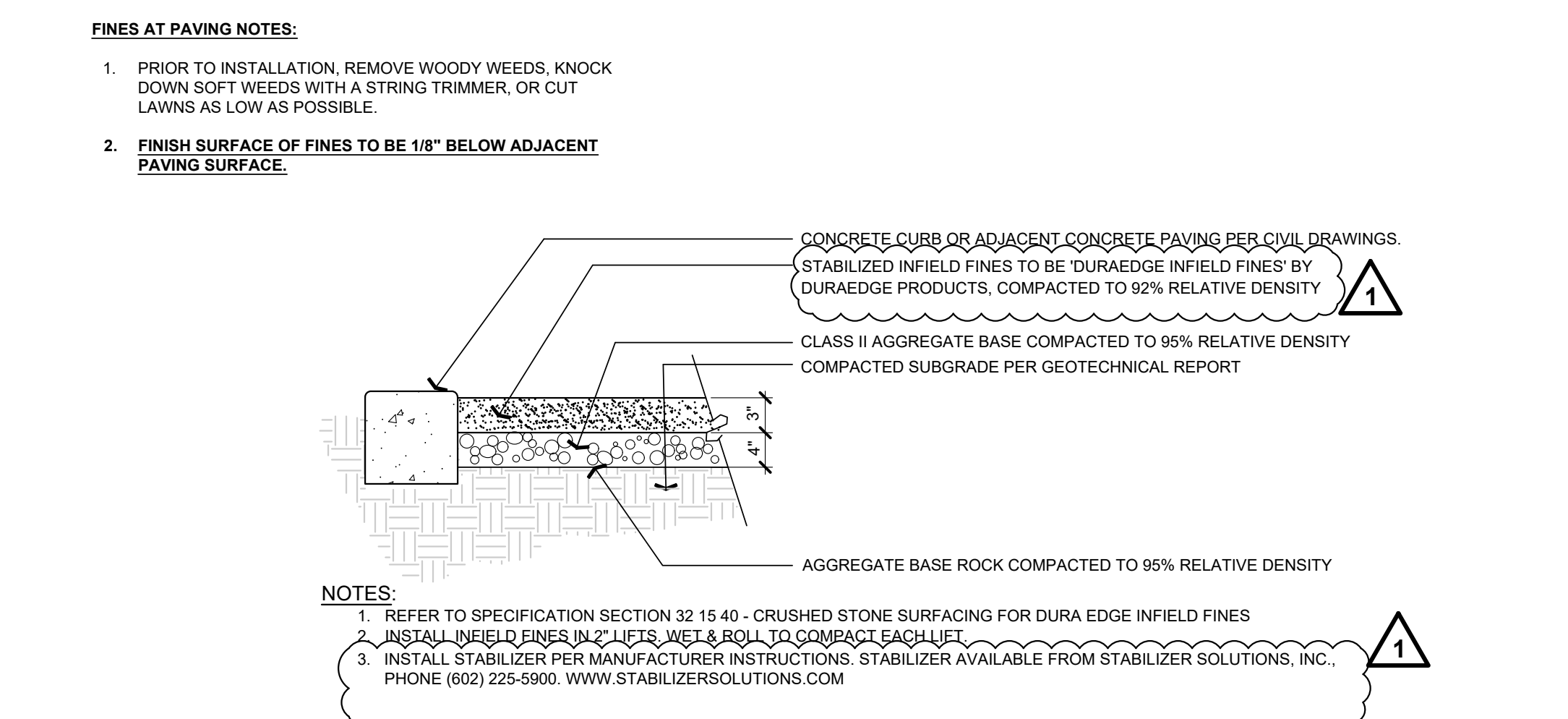

**G STABILIZED FINES AT PAVING**

SCALE: NTS

**D PITCHER'S MOUND**

SCALE: NTS

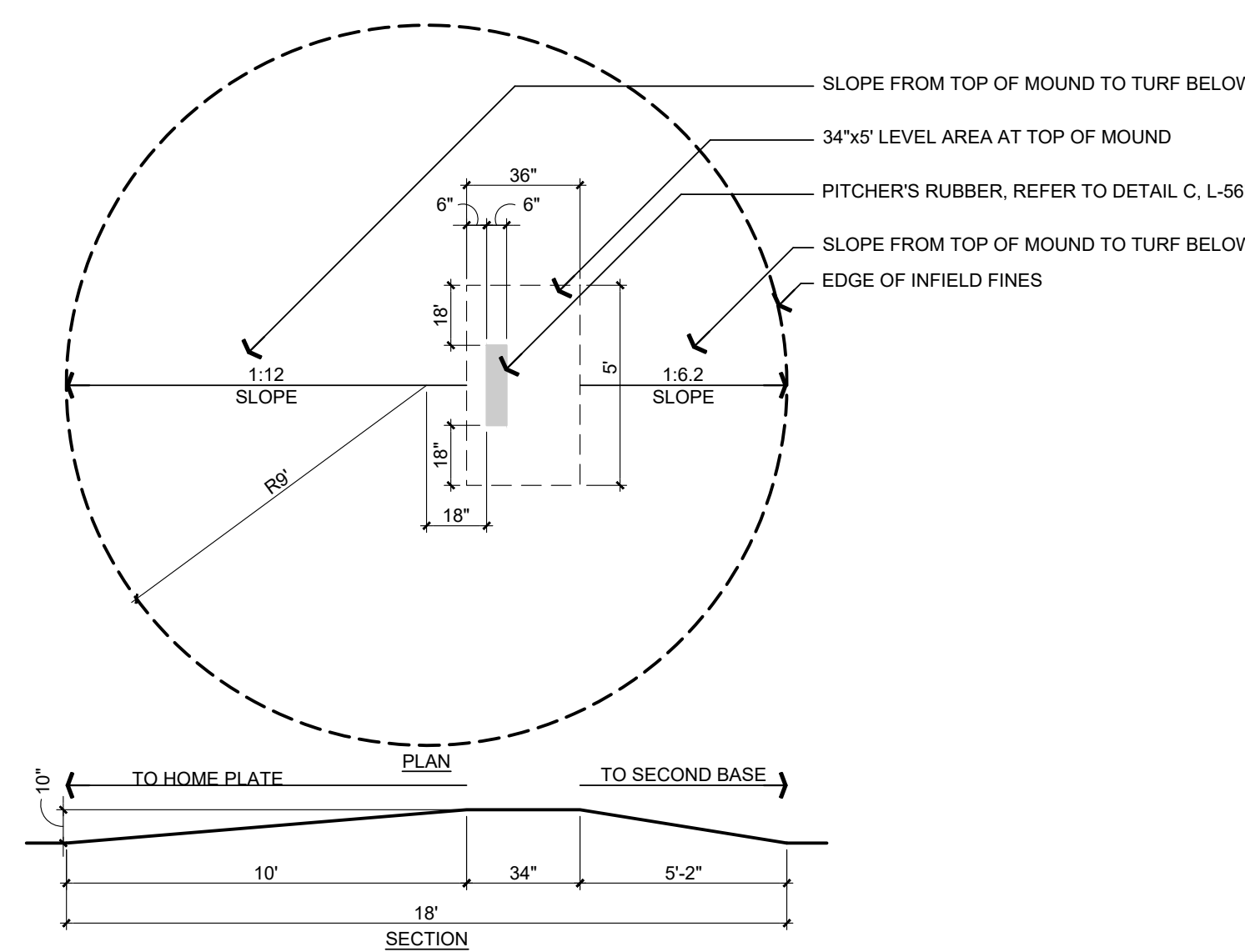

**D PITCHER'S MOUND**

**SOFTBALL**

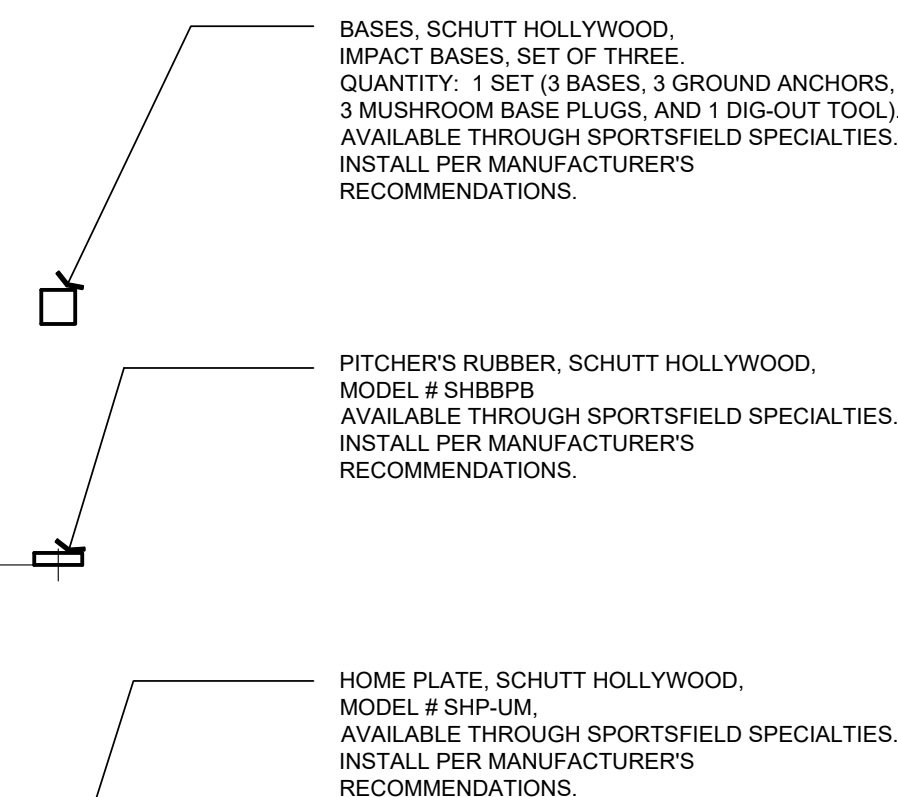

**A BASES, HOME PLATE, PITCHER'S RUBBER**

**BASEBALL**

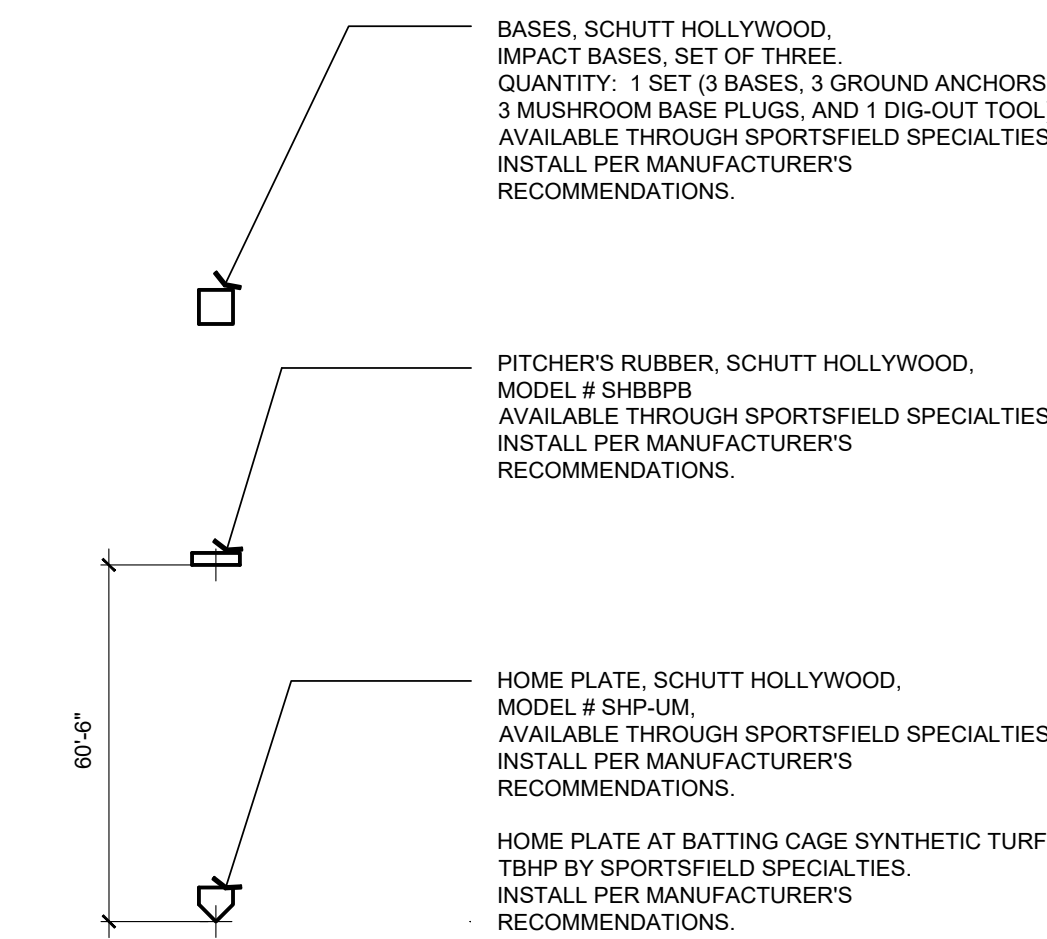

**A BASES, HOME PLATE, PITCHER'S RUBBER**

**NOTE:**  
1. INSTALL BASES OVER BASE ANCHORING PER DETAIL L-56A  
2. REFER TO DETAIL C, L-56D FOR BASE ANCHORING AT SYNTHETIC TURF.

**LIONAKIS**

2025 Nineteenth Street  
Sacramento CA 95818  
P 916.558.1900  
www.lionakis.com

CONSULTANT



1723 Hamilton Ave, Suite 101  
San Jose, CA 95125  
T. 408.292.2196  
www.anla-associates.com

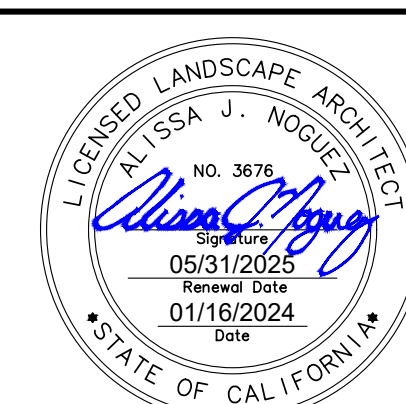

PROJECT  
**LUTHER BURBANK HIGH SCHOOL  
ATHLETIC FIELDS REPLACEMENT**

3500 FLORIN ROAD  
SACRAMENTO, CA 95823

CLIENT  
SACRAMENTO CITY UNIFIED SCHOOL DISTRICT  
5735 47TH AVENUE, SACRAMENTO, CA 95824

MARK	DATE	DESCRIPTION
-	08.10.2023	DSA INITIAL SUBMITTAL
-	12.07.2023	DSA BACKCHECK
-	01.16.2024	ADDENDUM

MANAGEMENT  
LIONAKIS PROJECT NO.  
CLIENT PROJECT NO.  
COPYRIGHT:

AGENCY

TITLE  
**CONSTRUCTION  
DETAILS**

SHEET  
**L-56B**

ANLA PROJECT NO. 2318

C:\Users\lnoat\OneDrive\Documents\Revit\lnoat\181973\_BM\_MASTER\_R18\_CENTRAL\_Unreleased.rvt 10/20/23 10:06:50 AM